

Reissued: 27-Aug-04

Model: Model C-C1	Date: 17-Nov-03	No.: MB173001a
-------------------	-----------------	----------------

## MB Correction

The items in bold italics have been corrected or added.

Modified Article: Parts catalog correction		Prepared by: T. Shintani	
From: 1st Technical Support Sec. Service Support Dept.			
Reason for Modification:	<input checked="" type="checkbox"/> Parts catalog correction <input type="checkbox"/> To facilitate assembly <input type="checkbox"/> Part standardization	<input type="checkbox"/> Vendor change <input type="checkbox"/> To improve reliability <input type="checkbox"/> Other	<input type="checkbox"/> To meet standards (      )
Modification Schedule:	From first mass production.		

Old part number	New part number	Description	Q'ty	Int	Page	Index	Note
B1739671	B1734231	Brand Plaque – B173 : RIC	1→1	<b><i>O/O</i></b>	8	2	1, 2

### Note:

#### 1. Applicable models:

<b><i>B173</i></b>			
<b><i>17</i></b>	<b><i>27</i></b>	<b><i>29</i></b>	<b><i>21</i></b>
	✓	✓	✓

2. This change applies only to the part number modification. This was done for parts number management.

Model: Model C-C1 China Model		Date: 22-Oct-04	No.: MB173002
Modified Article: Parts catalog correction		Prepared by: A. Ishiyama	
From: 1st Technical Support Sec. Service Support Dept.			
Reason for Modification:	<input checked="" type="checkbox"/> Parts catalog correction <input type="checkbox"/> To facilitate assembly <input type="checkbox"/> Part standardization	<input type="checkbox"/> Vendor change <input type="checkbox"/> To improve reliability <input type="checkbox"/> Other	<input type="checkbox"/> To meet standards (       )
Modification Schedule:	This new part is available from the first mass production.		

Old part number	New part number	Description	Q'ty	Int	Page	Index	Note
	H9169508	PSU – 220V	1	-	3	2	1
	B1739675	Fusing Unit – 220V : China	1		14	1	2

**Change/Reason:** These new parts were added for the C-C1 **China model (B173-21)** only.

**Note: Applicable models.**

B173				
	17	27	29	21
1				√
2				√

Model: Model C-C1 Asia Model		Date: 22-Oct-04	No.: MB173003
Modified Article: PCB - NCU		Prepared by: A. Ishiyama	
From: 1st Technical Support Sec. Service Support Dept.			
Reason for Modification:	<input checked="" type="checkbox"/> Parts catalog correction <input type="checkbox"/> To facilitate assembly <input type="checkbox"/> Part standardization	<input type="checkbox"/> Vendor change <input type="checkbox"/> To improve reliability <input type="checkbox"/> Other	<input type="checkbox"/> To meet standards (       )
Modification Schedule:	This new part is available from the first mass production.		

Old part number	New part number	Description	Q'ty	Int	Page	Index	Note
B1739516		PCB – NCU : NA	1→0	X/O	3	11	1
	B1739676	PCB – NCU : Asia	0→1				

**Change/Reason:** These new parts were added for the C-C1 **Asia model (B173-29) only.**

**Note: Applicable models:**

B173				
Part No.	17	27	29	21
B1739516	√			√
<b>B1739676</b>			√	

Model: Model C-C1 EU Model		Date: 18-Nov-04	No.: MB173004
Modified Article: PCB - NCU		Prepared by: A. Ishiyama	
From: 1st Technical Support Sec. Service Support Dept.			
Reason for Modification:	<input type="checkbox"/> Parts catalog correction <input type="checkbox"/> To facilitate assembly <input type="checkbox"/> Part standardization	<input type="checkbox"/> Vendor change <input type="checkbox"/> To improve reliability <input type="checkbox"/> Other	<input checked="" type="checkbox"/> To meet standards (For S. Africa regulation)
Modification Schedule:	This new part is available from the October '04 production.		

Old part number	New part number	Description	Q'ty	Int	Page	Index	Note
B1739515		PCB – NCU : EU	1→0	O/O*	3	11	1, 2
	B1739677	PCB – NCU : EU/SA	0→1				

**Change:** Board components were added/deleted.

**Reason:** To make the EU model usable in South Africa.

**Note:**

- See RTB RB173003 and B173002b for more details.
- There is a round, green seal on the new NCU.

**1. Applicable models:**

B173				
Part No.	17	27	29	21
B1739515		√		
<b>B1739677</b>		√		

- Applied to C-C1 EU model (B173-27) from: S/N **K2549423762 (Oct. 2004)**

**2. Interchangeability**

South Africa model: **Only the new board** can be used.

Europe model: Interchangeability is **O/O on all machines**.

**3. When you install the new NCU**

- 1) If you install the **new** NCU (B1739677), make sure to install firmware **v6.14 or later**.
- 2) When you install v6.14, make sure that the "LIU Select" setting is correct.  
(Tech Mode >> Data Setup >> LUI Setting):

- v6.14 + **New** NCU: Select **"EU&SA LIU"**
- v6.14 + **Old** NCU: Select: **"EU LIU"**

Model: Model C-C1		Date: 25-Mar-05	No.: MB173005
Modified Article: Harness - ADF		Prepared by: A. Ishiyama	
From: 1st Technical Support Sec. Service Support Dept.			
Reason for Modification:	<input checked="" type="checkbox"/> Parts catalog correction <input type="checkbox"/> To facilitate assembly <input type="checkbox"/> Part standardization	<input type="checkbox"/> Vendor change <input type="checkbox"/> To improve reliability <input type="checkbox"/> Other	<input type="checkbox"/> To meet standards ()
Modification Schedule:	This new part is available from the first mass production.		

Please apply the following P/N corrections to your Parts Catalogs.

Old part number	New part number	Description	Q'ty	Int	Page	Index	Note
	B1739678	HARNESS - ADF	0→1	-	7	25	

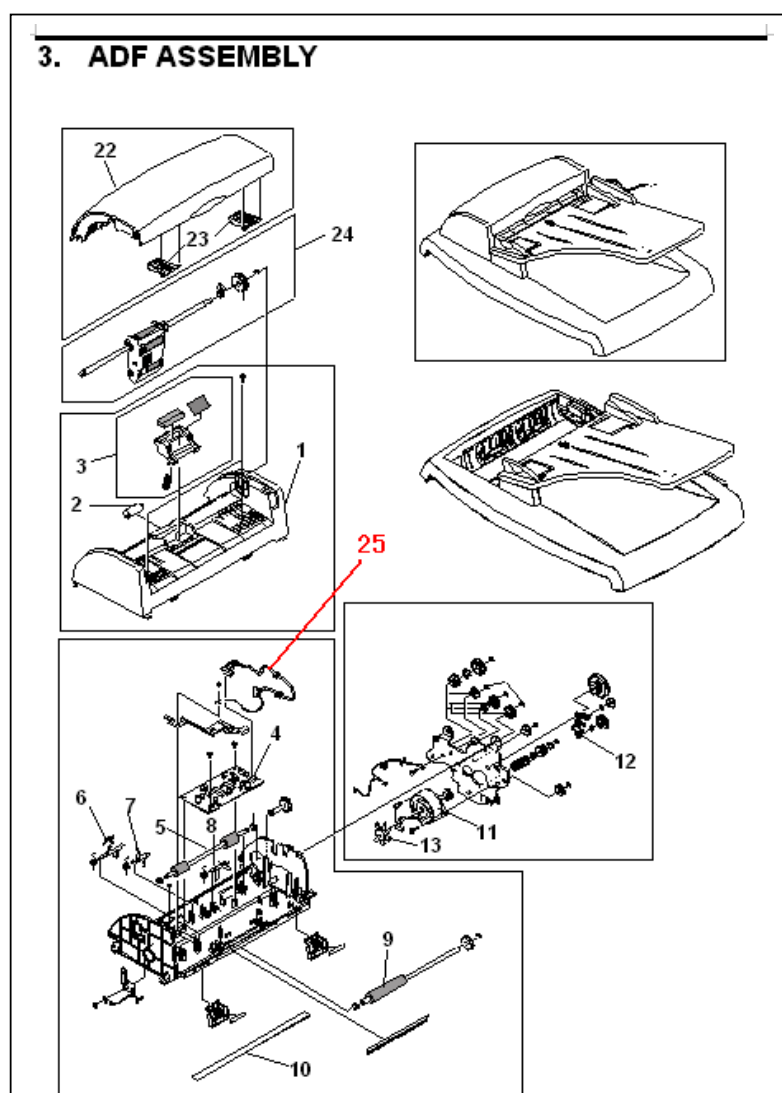

Model: Model C-C1		Date: 27-Sep-05	No.: MB173006
Modified Article: Scanner harness		Prepared by: T. Shintani	
From: 1st Technical Support Sec. Service Support Dept.			
Reason for Modification:	<input checked="" type="checkbox"/> Parts catalog correction <input type="checkbox"/> To facilitate assembly <input type="checkbox"/> Part standardization	<input type="checkbox"/> Vendor change <input type="checkbox"/> To improve reliability <input type="checkbox"/> Other	<input type="checkbox"/> To meet standards ()
Modification Schedule:	This new part is available from the first mass production.		

Please apply the following P/N corrections to your Parts Catalogs.

New part number	Description	Q'ty	Int	Page	Index	Note
B1739679	SCANNER HARNESS	0→1	-	2	13	

MAIN ASSEMBLY

27 February 2004

## 1. MAIN ASSEMBLY

